

REVISION		
DATE	NAME	L.S. NO.
11/99	R. E. BORUP JR., P.L.S.	12803
8/2004	M. J. McGurl P.L.S.	38338
3/2006	M. J. McGurl P.L.S.	38338
4/2007	M. J. McGurl P.L.S.	38338
3/2008	M. J. McGurl P.L.S.	38338
5/2008	M. J. McGurl P.L.S.	38338
5/2009	M. J. McGurl P.L.S.	38338
5/2010	M. J. McGurl P.L.S.	38338
4/2011	M. J. McGurl P.L.S.	38338
2/2012	M. J. McGurl P.L.S.	38338
4/2012	M. J. McGurl P.L.S.	38338
4/2013	M. J. McGurl P.L.S.	38338
2/2014	M. J. McGurl P.L.S.	38338
2/2015	M. J. McGurl P.L.S.	38338
2/2016	M. J. McGurl P.L.S.	38338

TOWNSHIP OF FRANKLIN  
SOMERSET COUNTY

TOWNSHIP OF  
SOUTH BRUNSWICK  
MIDDLESEX COUNTY

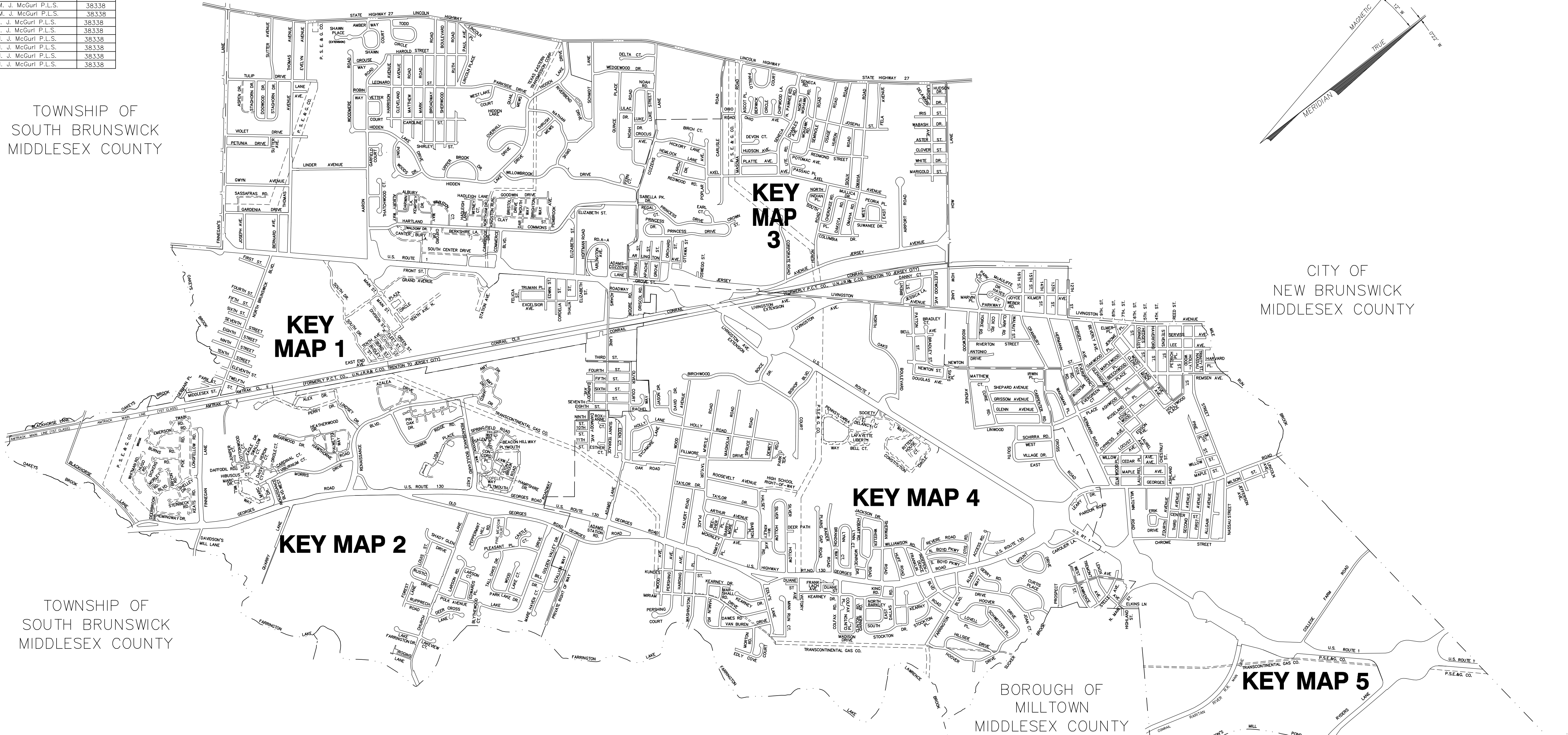
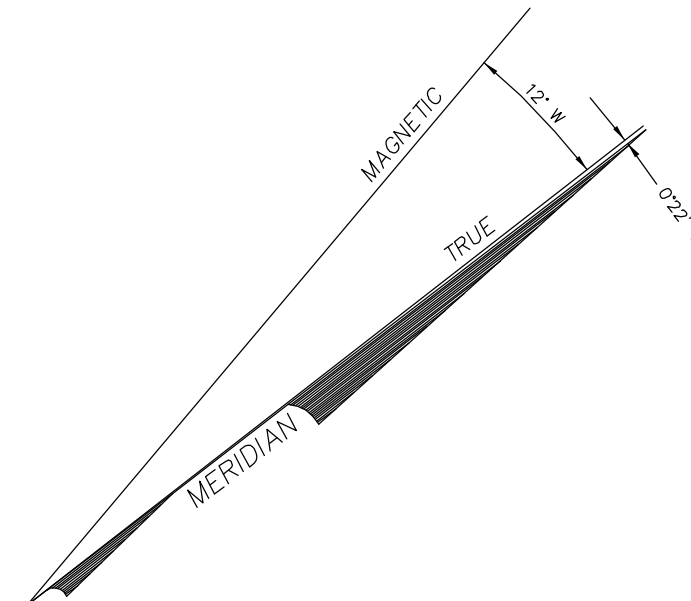

TOWNSHIP OF  
SOUTH BRUNSWICK  
MIDDLESEX COUNTY

TOWNSHIP OF EAST BRUNSWICK  
MIDDLESEX COUNTY

BOROUGH OF  
MILLTOWN  
MIDDLESEX COUNTY

TOWNSHIP OF EAST BRUNSWICK  
MIDDLESEX COUNTY

TAX MAP  
TOWNSHIP OF NORTH BRUNSWICK  
MIDDLESEX COUNTY, NEW JERSEY  
SCALE : 1" = 1200' JUNE 1998  
RAYMOND E. BORUP JR., P.L.S.  
CME ASSOCIATES  
3141 BORDENTOWN AVENUE, PARLIN  
NEW JERSEY, 08859  
TO SHOW CONDITIONS AS OF FEBRUARY 2015

LEGEND

- - - - - MUNICIPAL BOUNDARY
- \_\_\_\_\_ COUNTY BOUNDARY
- KEY MAP LIMIT

THE AREAS, BOUNDARIES AND DIMENSIONS, SHOWN ON THIS TAX MAP, ARE DERIVED FROM GROUND SURVEYS, AERIAL SURVEYS, AND RECORDED PLANS, MAPS, DEEDS, WILLS, AND ARE TO BE USED FOR ASSESSMENT PURPOSES ONLY.

THIS TAX MAP SUPERCEDES THE TAX MAP APPROVED JULY 29, 1982. I HEREBY CERTIFY THAT THIS MAP HAS BEEN REVISED UNDER MY IMMEDIATE SUPERVISION, AND COMPLIES WITH THE LAWS OF THE STATE OF NEW JERSEY.

RAYMOND E. BORUP JR., PROFESSIONAL LAND SURVEYOR  
NEW JERSEY LICENSE NO. 12803

