

REVISION			
DATE	NAME	P.L.S.	L.S. NO.
4/2007	M.J.McGAIL	P.L.S.	38338
3/2008	M.J.McGAIL	P.L.S.	38338
5/2009	M.J.McGAIL	P.L.S.	38338
2/2012	M.J.McGAIL	P.L.S.	38338
3/2017	M.J.McGAIL	P.L.S.	38338

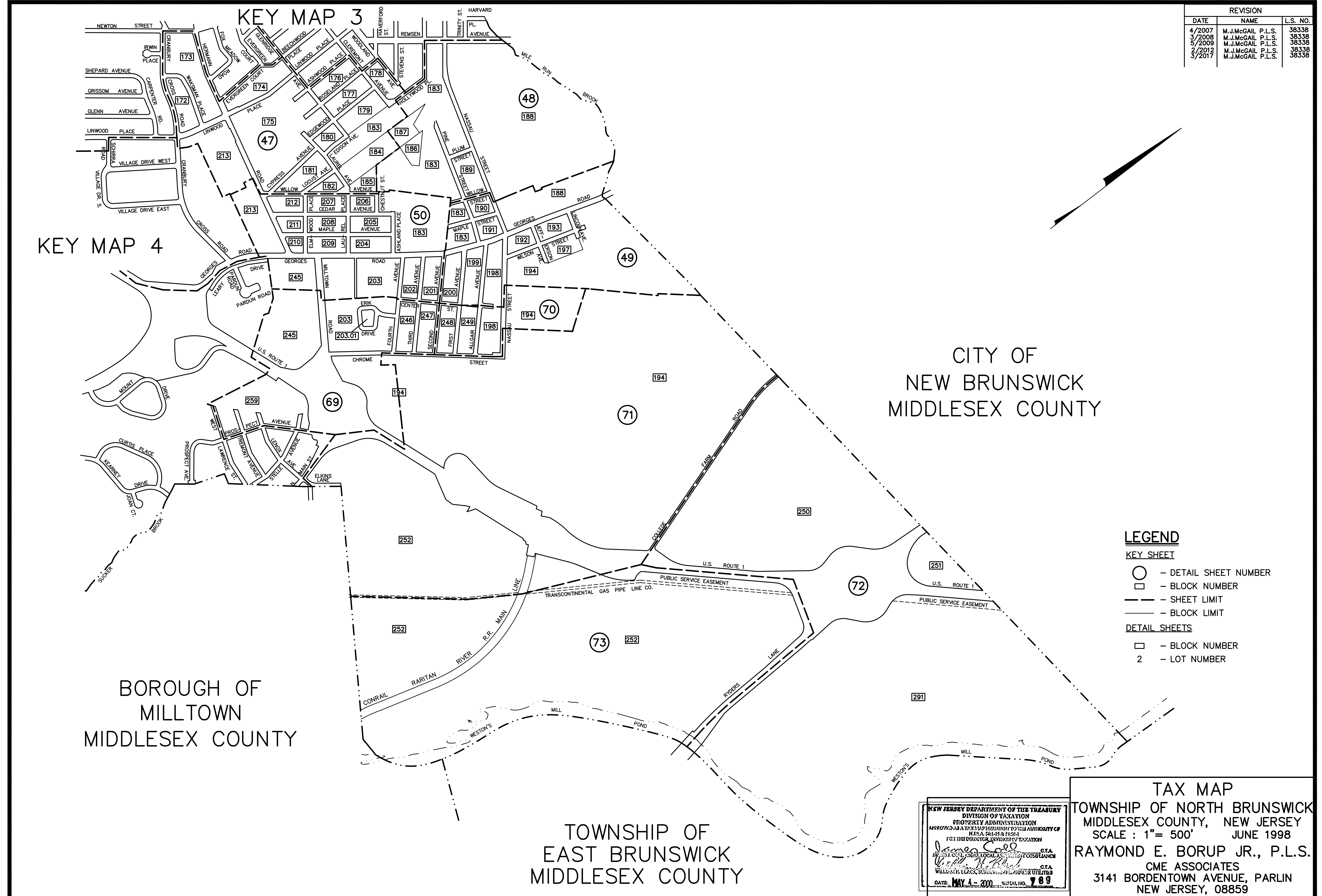

CITY OF
NEW BRUNSWICK
MIDDLESEX COUNTY

BOROUGH OF
MILLTOWN
MIDDLESEX COUNTY

TOWNSHIP OF
EAST BRUNSWICK
MIDDLESEX COUNTY

- LEGEND**
- KEY SHEET**
- - DETAIL SHEET NUMBER
 - - BLOCK NUMBER
 - - - SHEET LIMIT
 - — — BLOCK LIMIT
- DETAIL SHEETS**
- - BLOCK NUMBER
 - 2 - LOT NUMBER

NEW JERSEY DEPARTMENT OF THE TREASURY
DIVISION OF TAXATION
PROPERTY ADJUSTMENT SECTION
APPROVED AS A TAX MAP PURSUANT TO THE AUTHORITY OF
N.J.S.A. 54:15-8 & 15-9
FOR THE DIRECTOR, DIVISION OF TAXATION

James C. ... C.T.A.
William H. ... C.T.A.
WILLIAMS & BUCK, SUPERVISORS OF ENGINEERING UTILITIES
DATE: MAY 4 - 2000 SERIAL NO. 789

TAX MAP
TOWNSHIP OF NORTH BRUNSWICK
MIDDLESEX COUNTY, NEW JERSEY
SCALE : 1" = 500' JUNE 1998
RAYMOND E. BORUP JR., P.L.S.
CME ASSOCIATES
3141 BORDENTOWN AVENUE, PARLIN
NEW JERSEY, 08859