

REV.	BY	CHK.	DESCRIPTION
1/2018	REV. 218	REV. 218	REVISION
2/2018	REV. 218	REV. 218	REVISION
3/2018	REV. 218	REV. 218	REVISION
4/2018	REV. 218	REV. 218	REVISION
5/2018	REV. 218	REV. 218	REVISION
6/2018	REV. 218	REV. 218	REVISION
7/2018	REV. 218	REV. 218	REVISION
8/2018	REV. 218	REV. 218	REVISION
9/2018	REV. 218	REV. 218	REVISION
10/2018	REV. 218	REV. 218	REVISION
11/2018	REV. 218	REV. 218	REVISION
12/2018	REV. 218	REV. 218	REVISION

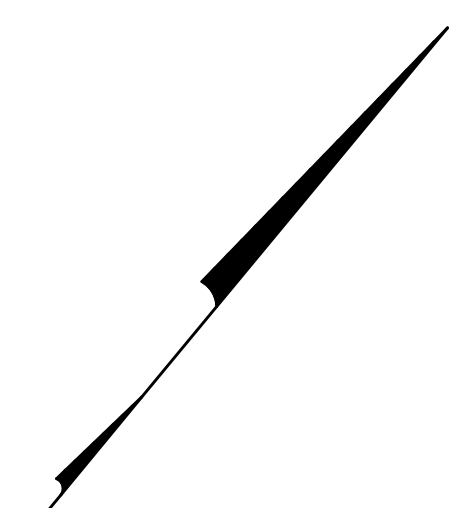

SHEET 55

SHEET 53

SHEET 66

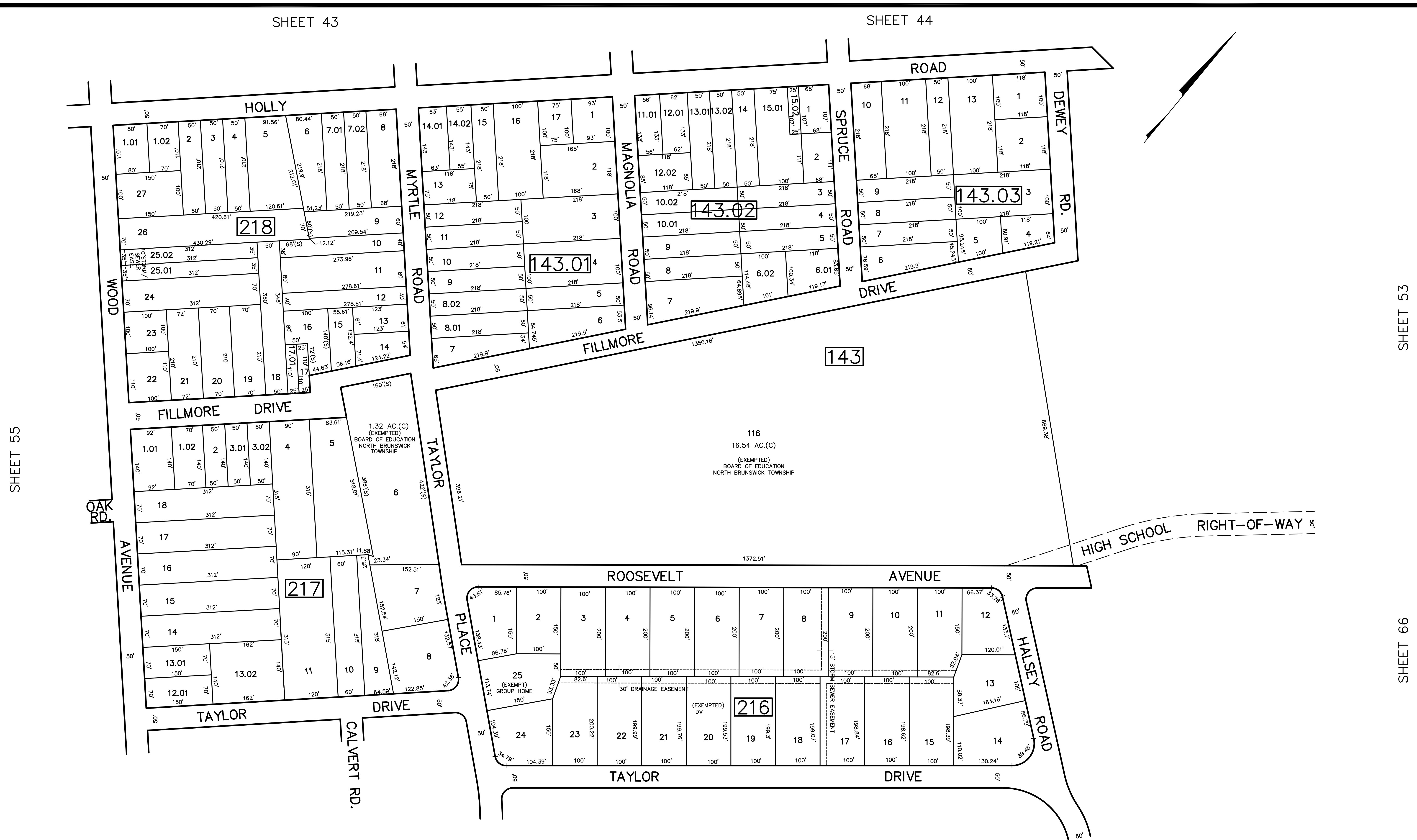

NEW JERSEY DEPARTMENT OF THE TREASURY  
 DIVISION OF TAXATION  
 PROPERTY ADJUSTMENT  
 APPROVED AS A TAX MAP PURSUANT TO THE AUTHORITY OF  
 N.J.S.A. 54:15-2 & 15-3  
 FOR THE DIRECTOR, DIVISION OF TAXATION  
*James S. ...* C.T.A.  
 DATE: MAY 4, 2000 SERIAL NO. 789

TAX MAP  
 TOWNSHIP OF NORTH BRUNSWICK  
 MIDDLESEX COUNTY, NEW JERSEY  
 SCALE : 1" = 100' JUNE 1998  
 RAYMOND E. BORUP JR., P.L.S.  
 CME ASSOCIATES  
 3141 BORDENTOWN AVENUE, PARLIN  
 NEW JERSEY, 08859