

THESE PLANS ARE INSTRUMENTS OF SERVICE AND ARE THE PROPERTY OF THE ARCHITECT. INFRINGEMENTS WILL BE PROSECUTED.
CONTRACTOR SHALL VERIFY ALL FIELD CONDITIONS AND DIMENSIONS AND BE RESPONSIBLE FOR FIELD FIT AND QUANTITY OF WORK. NO ALLOWANCES SHALL BE MADE ON BEHALF OF THE CONTRACTOR FOR ANY ERROR OR NEGLIGENCE ON HIS PART.

REVISIONS

NO.	DATE	DESCRIPTION

PROJECT TITLE

INTERIOR ALTERATIONS TO
EXISTING RESTAURANT AT
360 GEORGES ROAD UNIT GHG
NEW BRUNSWICK
NEW JERSEY

523 DESIGN GROUP L.L.C.
523 SECOND STREET, SUITE 1
PALISADES PARK, NJ 07650

TEL 201 786 3706
FAX 201 947 2113
EM ARKIVILD@YAHOO.COM

JAMES J.H. CHAI A.I.A.
NJ LIC.No. 01401889800
NY LIC.No. 035550
J.H. SONG
N.J.C.I.D. No. 00140

CONSTRUCTION NOTES

FIRST FLOOR PLAN		
BUILDING DATA, SITE PLAN		
DATE	OCT '21	DRAWING NO.
COMM NO.	19 - BQS	A-1
SCALE	AS NOTED	
DRAWN BY	ARK	
CHECKED BY	JHC	
		1 OF 5

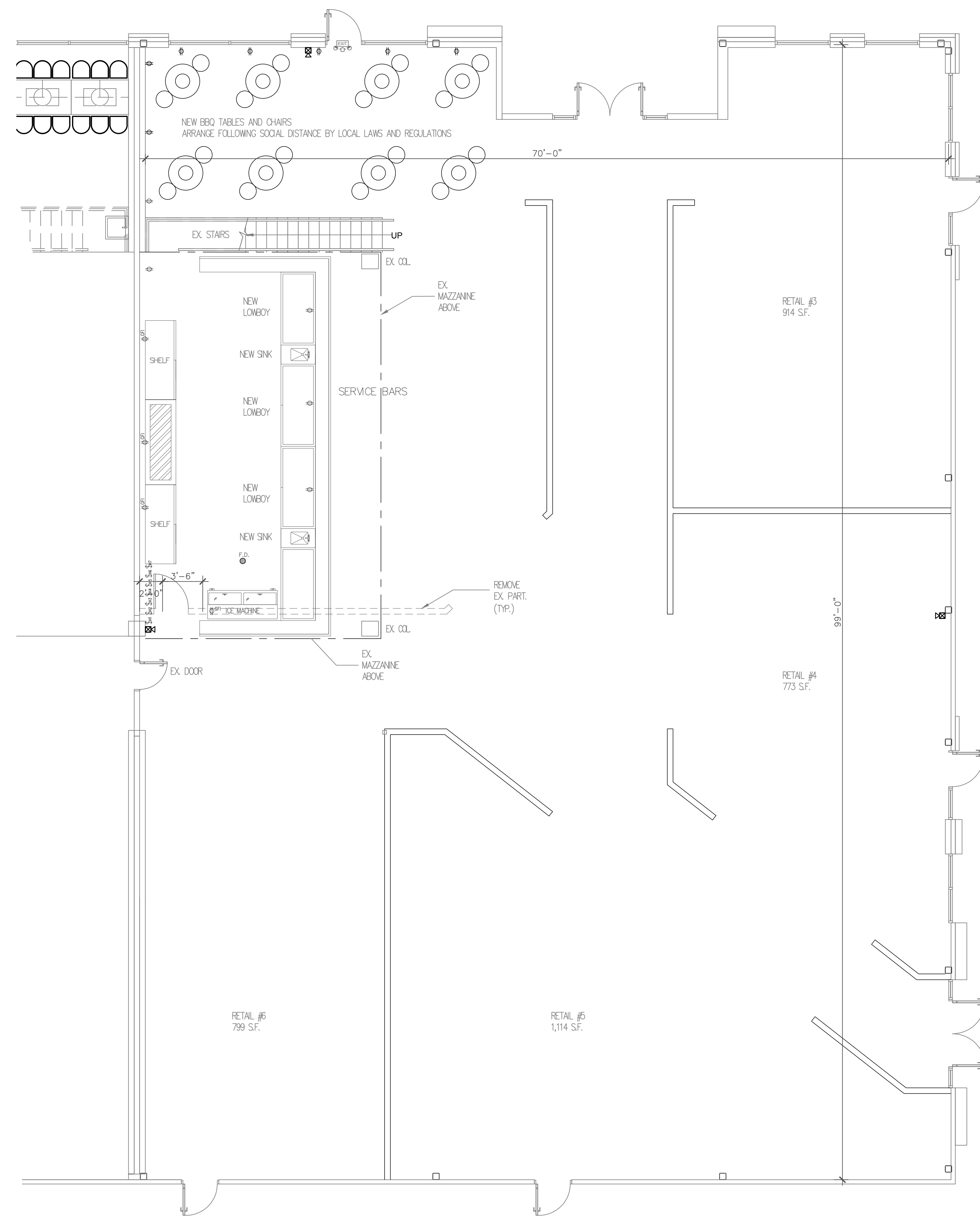

FIRST FLOOR PLAN
SCALE : 3/16"=1'-0"

SYMBOLS

- EXISTING COLUMN
- DETAIL DESIGNATION SPOT DETAIL DRAWING NUMBER
- SURFACE ELEVATION ELEVATION HEIGHT
- ROOM NUMBER
- REVISION TO DRAWING
- EXISTING WORK TO BE REMOVE
- TWO (2) HOUR FIRE RATED PARTITION
- EXISTING WALL
- NEW CMU FOUNDATION WALL
- NEW PARTITION
- GAS OUTLET
- SWITCH
- THREE WAY SWITCH
- DIMMER SWITCH
- DUPLEX RECEPTACLE
- GROUND FAULT DUPLEX RECEPTACLE
- RECESSED CEILING LIGHT FIXTURE
- CEILING MOUNTED LIGHT FIXTURE
- WATERPROOF LIGHT FIXTURE
- PENDANT LIGHT
- EXHAUST FAN
- SMOKE DETECTOR
- HEAT DETECTOR
- CARBON MONOXIDE DETECTOR
- ELECTRIC PANEL
- DOOR EX. PART.
- HALO H7T, 6" NON IC RD HOUSING W/ HALO 426 TRIMS AND 14W LED FLOOD LAMP
- EMERG. LIGHT / EXIT SIGN CONN. TO EX. ELEC. SYSTEM W/ BACK UP BATTERY QLXN500R/G-2MRS
- DUAL HEAD EMERG. LIGHT CONN. TO EX. ELEC. SYSTEM W/ BACK UP BATTERY LCA-MRS

DESCRIPTION OF WORK

INSTALL NEW BBQ TABLES / CHAIRS AND NEW DRINKING BAR / STOOL
NUMBER OF NEW BBQ TABLES / CHAIR: 16 / 48
NUMBER OF NEW DRINKING BAR / STOOL:
TOTAL TABLE / CHAIRS: 16 / 48

CODE COMPLIANCE

INT'L BUILDING CODE NJ ED. 2018
NATIONAL ELECTRICAL CODE 2017
NATIONAL STANDARD PLUMBING CODE 2018
INT'L ENERGY CONSERVATION CODE 2018
INTERNATIONAL MECHANICAL CODE 2018
INTERNATIONAL FUEL GAS CODE 2018
REHABILITATION SUBCODE NJAC 5:23-6
BARRIER-FREE SUBCODE NJAC 5:23-7
ICC / ANSI A117.1-2009

BLDG. DATA

CONSTRUCTION TYPE : 2 A
USE GROUP : A-2 (RESTAURANT)
SPECIFIC USE : BARBEQUE RESTAURANT
AREA IN USE: 7,277 SF

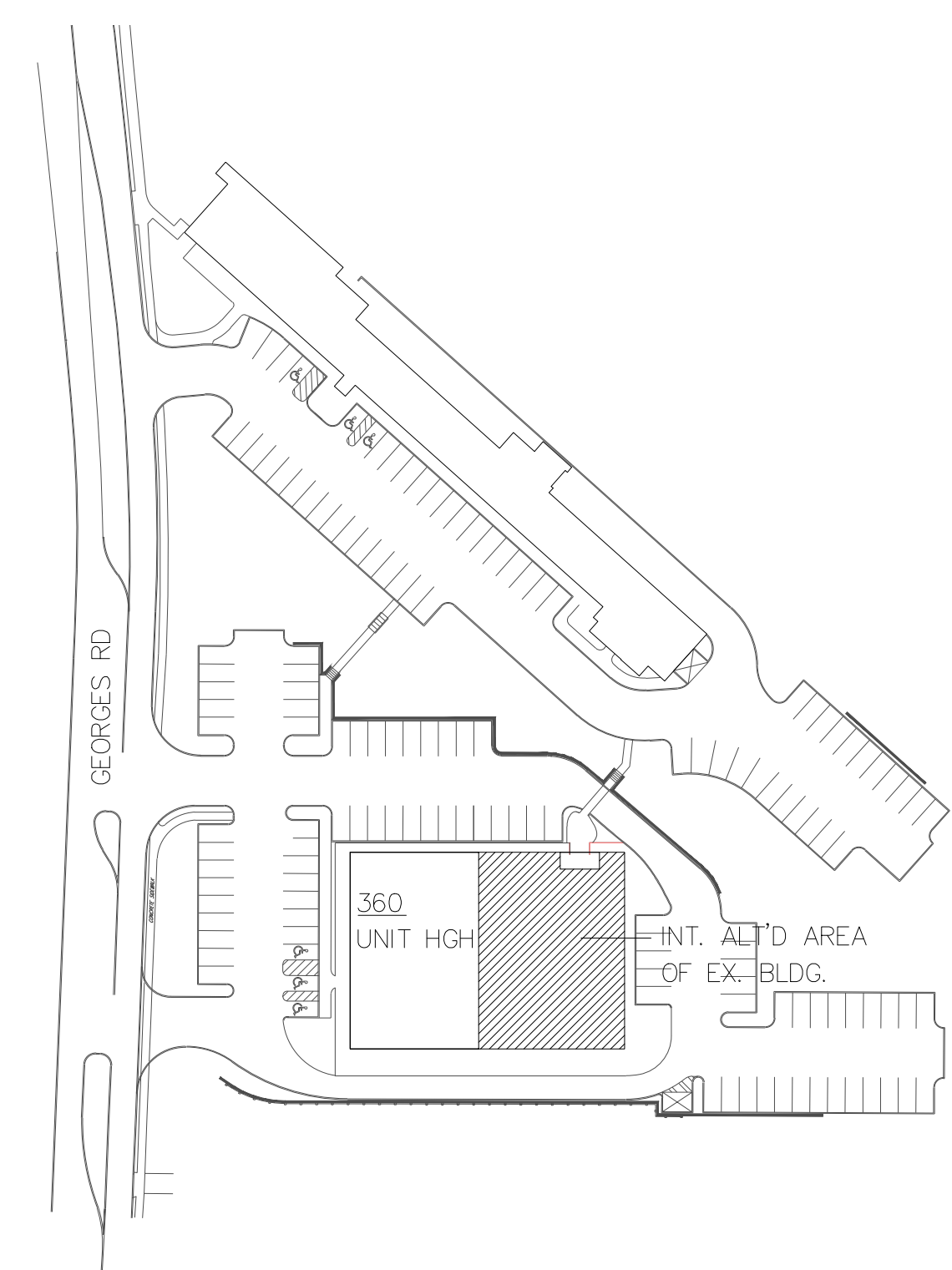

SITE PLAN

NOT TO SCALE
NOTE:
SITE PLAN DATA TAKEN FROM SURVEY PREPARED BY COSTA ENGINEERING CORP., PROFESSIONAL ENGINEERS & PLANNERS SURVEYORS HACKENSACK, NJ, DATED FEB. 24, 2006.