

# Exhibit A

## Demised Premises

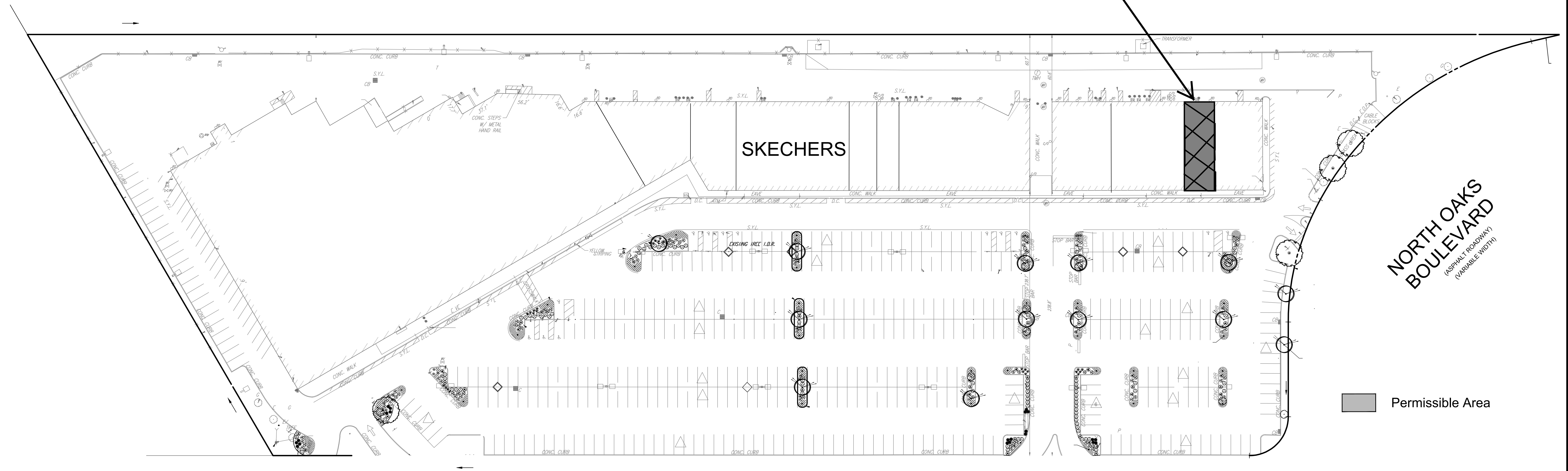
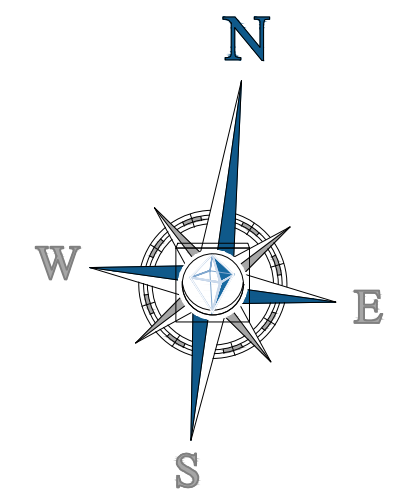

NEW JERSEY STATE HIGHWAY ROUTE U.S. 1  
(A.K.A. STATE HIGHWAY ROUTE NO. 26)  
(ASPHALT ROADWAY)  
(134.5' WIDE)

SOUTH BOUND TRAFFIC  
←

Permissible Area

NORTH OAKS  
BOULEVARD  
(ASPHALT ROADWAY)  
(VARIABLE WIDTH)