

REVISION		
DATE	NAME	L.S. NO.
11/99	R. E. BORUP JR., P.L.S.	12803
8/2004	M. J. McGurl P.L.S.	38338
3/2006	M. J. McGurl P.L.S.	38338
4/2007	M. J. McGurl P.L.S.	38338
3/2008	M. J. McGurl P.L.S.	38338
5/2008	M. J. McGurl P.L.S.	38338
5/2009	M. J. McGurl P.L.S.	38338
5/2010	M. J. McGurl P.L.S.	38338
4/2011	M. J. McGurl P.L.S.	38338
2/2012	M. J. McGurl P.L.S.	38338
4/2012	M. J. McGurl P.L.S.	38338
4/2013	M. J. McGurl P.L.S.	38338
2/2014	M. J. McGurl P.L.S.	38338
2/2015	M. J. McGurl P.L.S.	38338
2/2016	M. J. McGurl P.L.S.	38338
3/2019	M. J. McGurl P.L.S.	38338
1/2020	M. J. McGurl P.L.S.	38338
4/2022	M. J. McGurl P.L.S.	38338
4/2023	M. J. McGurl P.L.S.	38338

TOWNSHIP OF SOUTH BRUNSWICK
MIDDLESEX COUNTY

TOWNSHIP OF FRANKLIN
SOMERSET COUNTY

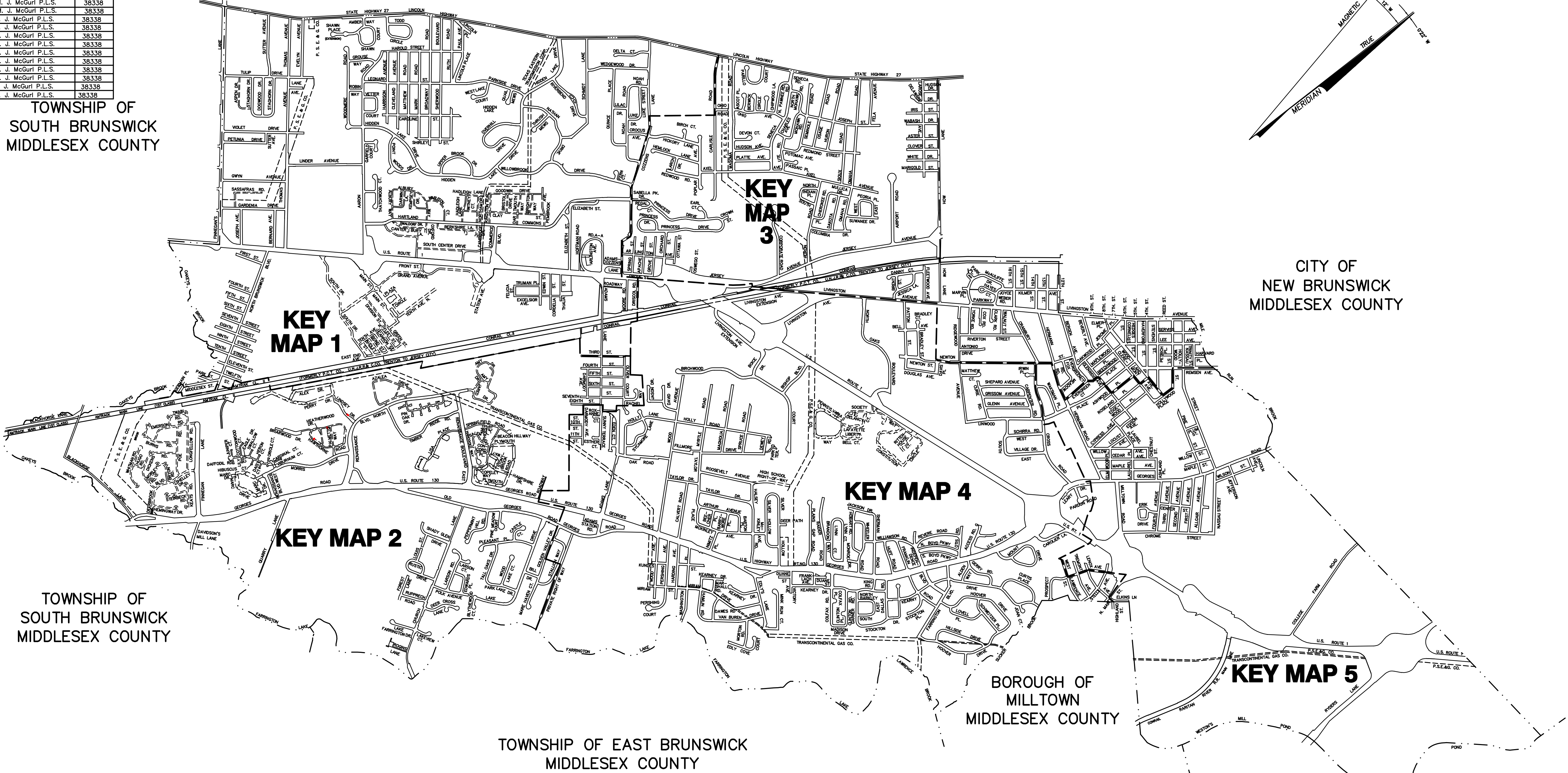
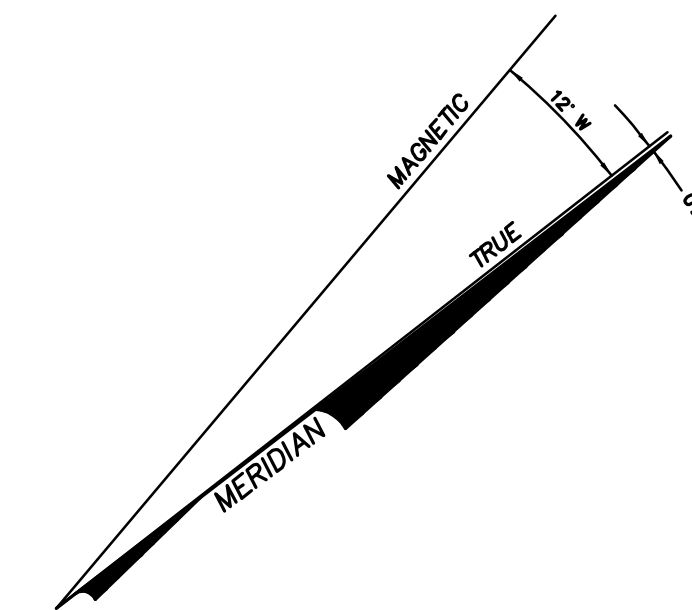

CITY OF NEW BRUNSWICK
MIDDLESEX COUNTY

TOWNSHIP OF SOUTH BRUNSWICK
MIDDLESEX COUNTY

BOROUGH OF MILLTOWN
MIDDLESEX COUNTY

TOWNSHIP OF EAST BRUNSWICK
MIDDLESEX COUNTY

TOWNSHIP OF EAST BRUNSWICK
MIDDLESEX COUNTY

LEGEND

- - - - - MUNICIPAL BOUNDARY
- _____ COUNTY BOUNDARY
- - - - - KEY MAP LIMIT

THE AREAS, BOUNDARIES AND DIMENSIONS, SHOWN ON THIS TAX MAP, ARE DERIVED FROM GROUND SURVEYS, AERIAL SURVEYS, AND RECORDED PLANS, MAPS, DEEDS, WILLS, AND ARE TO BE USED FOR ASSESSMENT PURPOSES ONLY.

THIS TAX MAP SUPERCEDES THE TAX MAP APPROVED JULY 29, 1982. I HEREBY CERTIFY THAT THIS MAP HAS BEEN REVISED UNDER MY IMMEDIATE SUPERVISION, AND COMPLIES WITH THE LAWS OF THE STATE OF NEW JERSEY.

RAYMOND E. BORUP JR., PROFESSIONAL LAND SURVEYOR
NEW JERSEY LICENSE NO. 12803

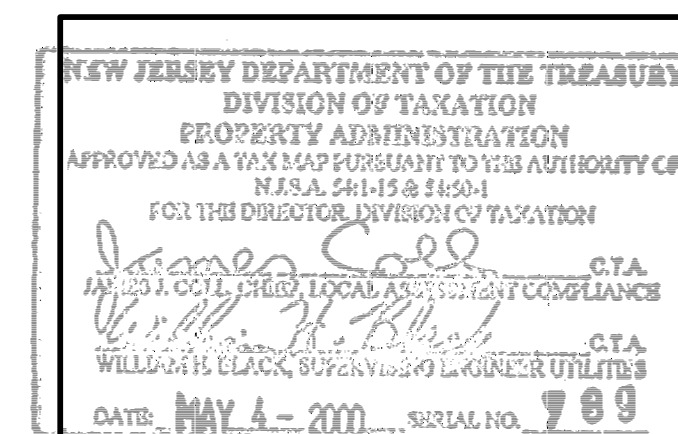

TAX MAP
TOWNSHIP OF NORTH BRUNSWICK
MIDDLESEX COUNTY, NEW JERSEY
SCALE : 1" = 1200' JUNE 1998
RAYMOND E. BORUP JR., P.L.S.
CME ASSOCIATES
3141 BORDENTOWN AVENUE, PARLIN
NEW JERSEY, 08859
TO SHOW CONDITIONS AS OF APRIL 2023