

REVISION		
DATE	NAME	L.S. NO.
6/2004	MICHAEL Mc GURL P.L.S.	38338
3/2006	MICHAEL Mc GURL P.L.S.	38338
4/2007	MICHAEL Mc GURL P.L.S.	38338
2/2012	MICHAEL Mc GURL P.L.S.	38338
4/2013	MICHAEL Mc GURL P.L.S.	38338
2/2014	MICHAEL Mc GURL P.L.S.	38338
2/2020	MICHAEL Mc GURL P.L.S.	38338
2/2023	MICHAEL Mc GURL P.L.S.	38338

KEY MAP 1

TOWNSHIP OF
SOUTH BRUNSWICK
MIDDLESEX COUNTY

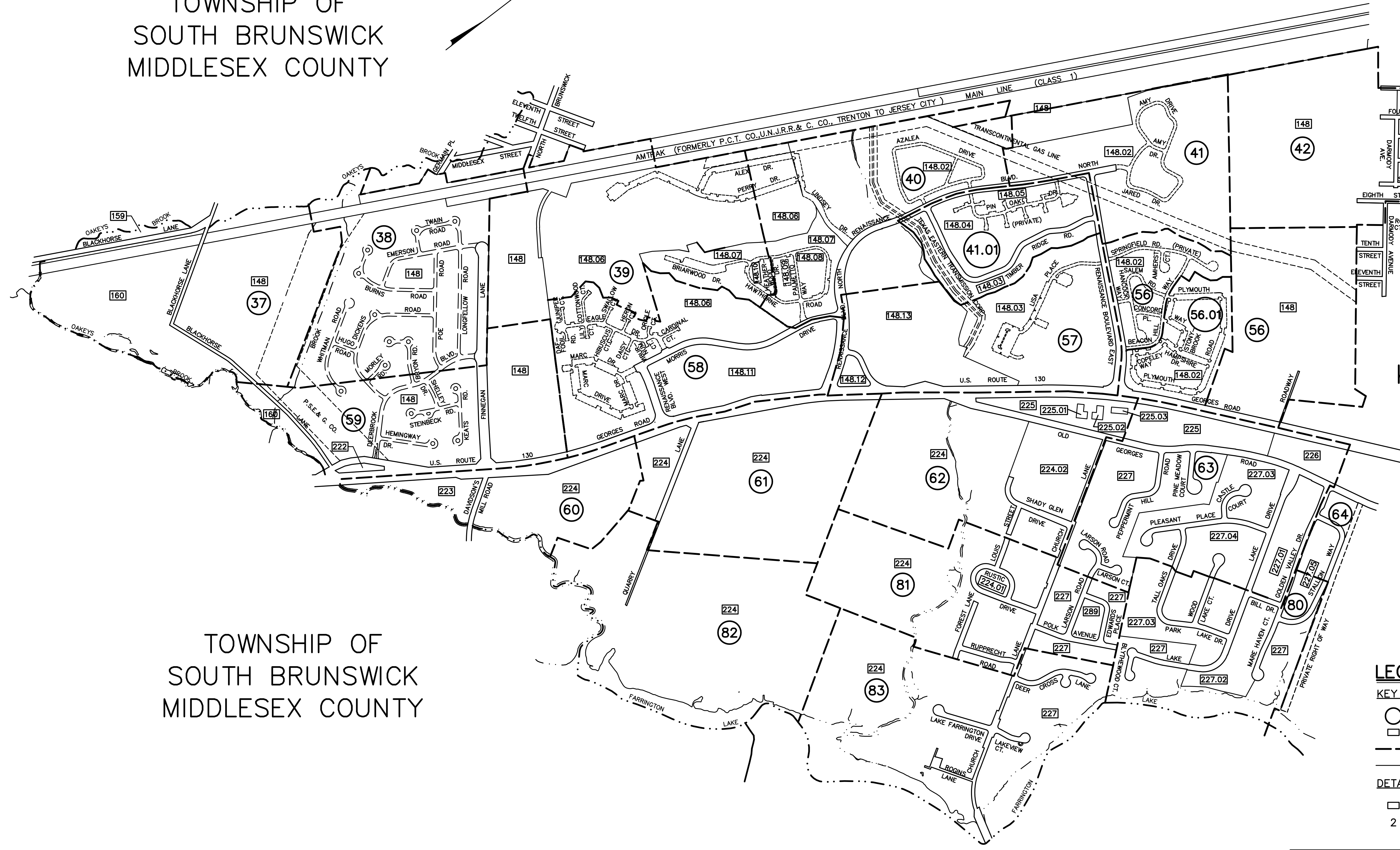

KEY MAP 4

TOWNSHIP OF
SOUTH BRUNSWICK
MIDDLESEX COUNTY

TOWNSHIP OF
EAST BRUNSWICK
MIDDLESEX COUNTY

LEGEND

- KEY SHEET**
- - DETAIL SHEET NUMBER
 - - BLOCK NUMBER
 - - SHEET LIMIT
 - - BLOCK LIMIT
- DETAIL SHEETS**
- - BLOCK NUMBER
 - 2 - LOT NUMBER

NEW JERSEY DEPARTMENT OF THE TREASURY
DIVISION OF TAXATION
PROPERTY ADMINISTRATION
APPROVED AS A TAX MAP PURSUANT TO THE AUTHORITY OF
N.J.S.A. 54:15 & 16-21
FOR THE COLLECTOR, TRIVENTURE TAXATION

James S. Galt C.T.A.
WILLIAM BLICK SUPERVISOR OF ENGINEERING UTILITIES
DATE: MAY 4 - 2000 SERIAL NO. 789

TAX MAP
TOWNSHIP OF NORTH BRUNSWICK
MIDDLESEX COUNTY, NEW JERSEY
SCALE : 1" = 500' JUNE 1998
RAYMOND E. BORUP JR., P.L.S.
CME ASSOCIATES
3141 BORDENTOWN AVENUE, PARLIN
NEW JERSEY, 08859